



DISC CHIPPER (HORIZONTAL FED)

LONG LOGS EXPERTLY HANDLED WITH HORIZONTAL FEEDS

Our disc chippers produce high-quality wood chips that meet the exact specifications of various industries. Over 60 years of continuous development and experience from applications in the board, sawmill, pulp and paper, and bioenergy sectors have resulted in a highly flexible machine program for all possible customer requirements.



For wood-processing operators that predominantly handle longer logs, we have the ideal disc chipper. The horizontal-fed Bruks disc chipper is particularly well suited for long logs as well as cut offs and slabs, including conversion of any sawmill residues. All wood products are processed into quality chips that are used for the pulp and paper industry.

Our wide product range starts with small diameter discs, up to high-capacity chippers with disc diameters of up to 3.0m and 2,500kW of installed power. Bruks horizontal-fed disc chippers can process up to 650m³ of chips per hour, with adjustable chip lengths from 20-50mm. Options are also available for different knife arrangements.

FACTS

PRODUCT AREA:

- Chipping

SCAN THE QR-CODE:

And view the Page online, where you will have access to more information





SAFE KNIFE CONTROL

All our larger disc chippers have a knife holding system to make handling the knives as easy and safe as possible. The knives are fitted in two sections and mounted in cassettes so that light-weight knives can be used.

Knife length can be adjusted using screws prior to fitting, which ensures the correct knife length as well as fast and easy knife changes. Chip length can be altered by changing knife shims and moving the disc. As an optional extra, the disc on our largest chipper can be rotated for a knife change via an electro-pneumatic inching drive.

When knives need to be changed, the chipper hood is raised hydraulically. However, to maximize safety, it is locked while the chipper disc is rotating and cannot be opened until the disc has come to a dead stop. Furthermore, the chipper cannot be restarted as long as the hood is open.

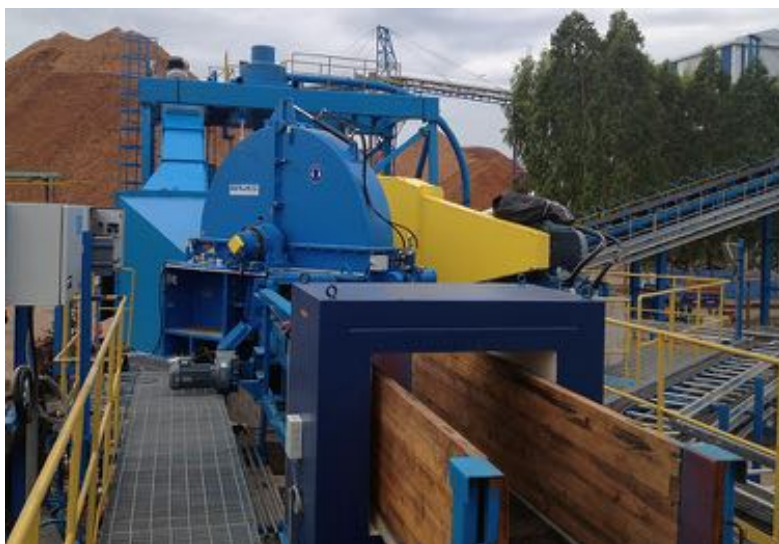

MAXIMIZING WEAR PARTS

Like our entire wood-chipper range, we have focused our designs on maximizing the service life of wear parts. The horizontal-fed Bruks disc chipper has a heavy-duty design, easy access for maintenance and replaceable wear parts that ensure long machine life and maximum availability.

All wear parts on the chipper are generously dimensioned and easily exchangeable. Bolted wear plates in sections protect the chipper's in-feed side of the disc and their fittings make them easy to exchange when needed. The same applies to the bolted wear plates on the base and side of the feed chute.

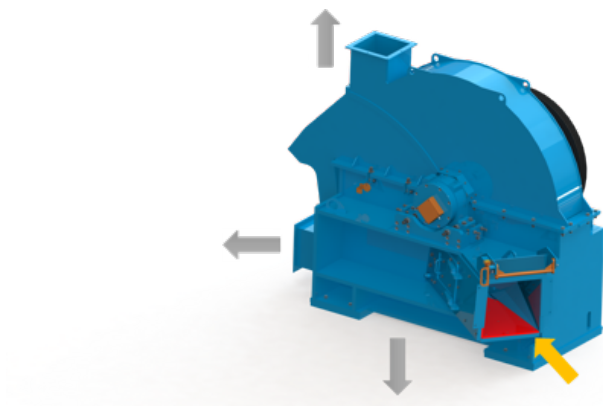

Image: There are three possible discharge directions on the Bruks horizontal-fed disc chipper: upwards, downwards or sideways

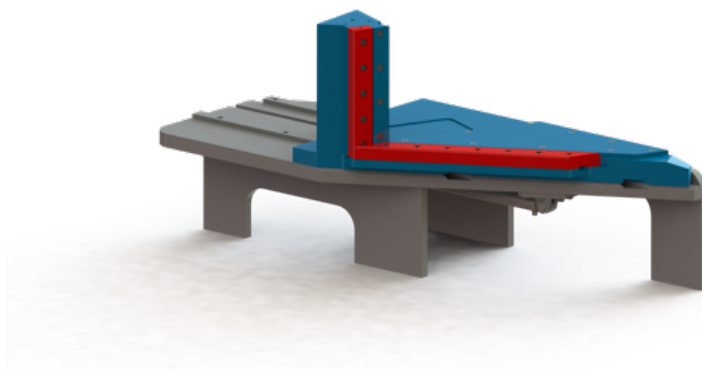

Image: Counter-knife extraction: horizontal and vertical counter knife. On larger models, hydraulic extraction is an option

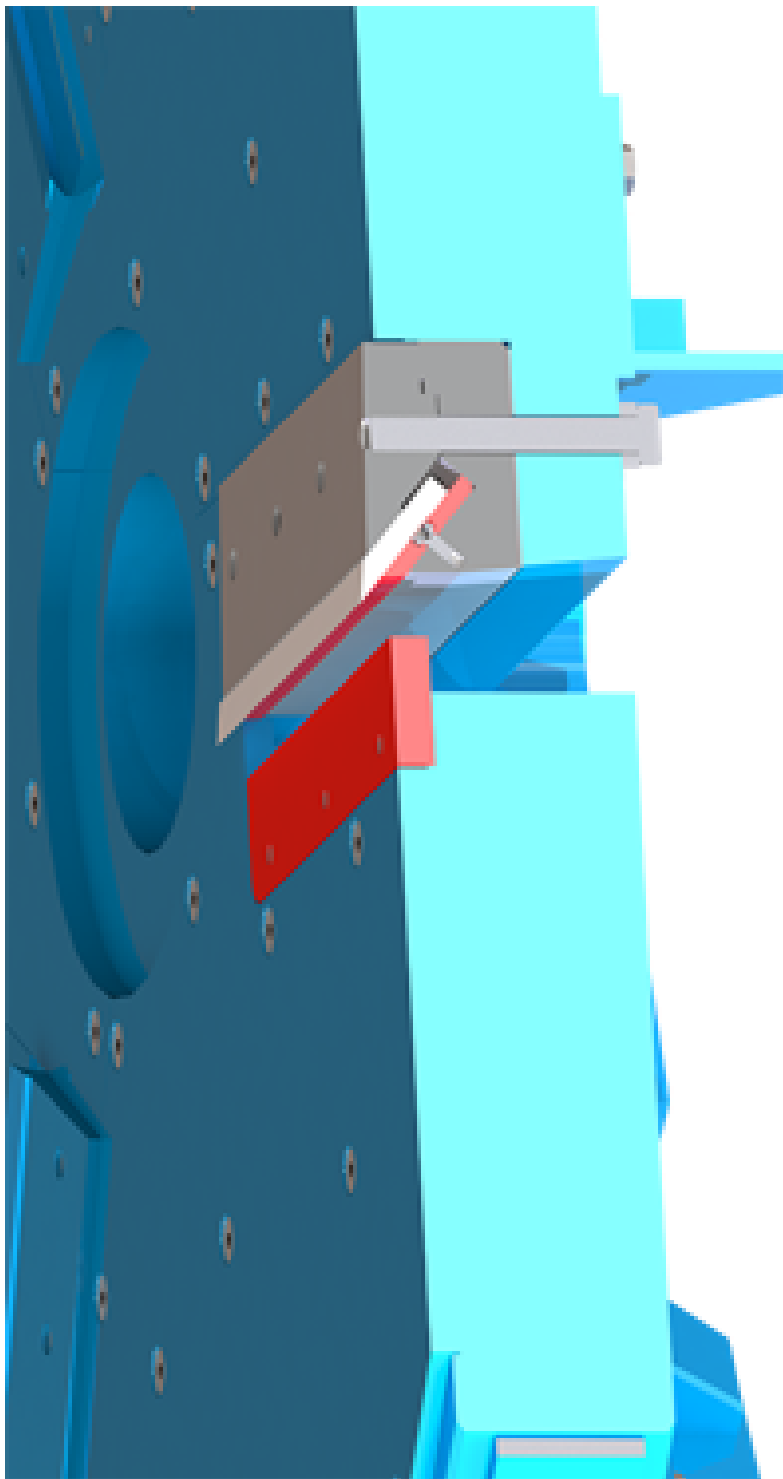

Image: Knife cassettes with wear plates and knives for easy knife handling

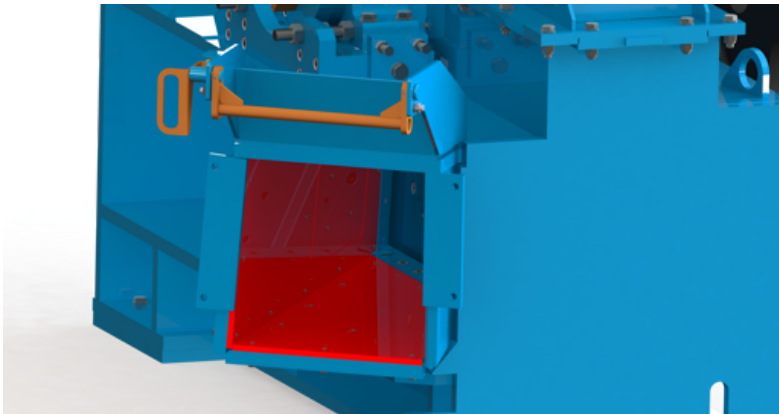

Image: The in-feed chutes (in red) on ware plates are equipped with replaceable wear liners

TECHNICAL DATA

Type	RH 1500	RH 2000	RH 2500	RH 3000
Feeding width [mm]	330	470	635	670
Disc diameter [mm]	1490	1990	2490	2990
Motor power [kW]	110-200	250-450	400-800	1200-2000

RELATED PRODUCTS WITHIN THE SAME PRODUCT AREA:

- [Disc chipper \(drop fed\)](#)
- [Disc chipper \(horizontal fed\)](#)
- [Drum chipper \(gravity\)](#)
- [Drum chipper \(horizontal\)](#)
- [Mobile chippers](#)